

BIG EASY PROVIDES BIG INCENTIVES

STORY BY COREY VAUGHN

The Michoud facility in New Orleans has a history of providing some of the most exciting work in Louisiana. Since 1961, it has been the site where NASA workers would assemble pieces that would eventually be launched into space. In recent years, the facility has once again become a creative hub, as well as a source for jobs, but this time the facility is launching film productions instead of spacecraft.



The poetic appeal of such a venue would be tempting for any filmmaker, but Big Easy Studios is far from having its head in the clouds. Founded by Herbert Gains, who has over 40 years of experience in the film industry, Big Easy Studios has become one of the most reliable and consistent production sites for big-budget film projects.

"I sat down with the people at NASA, and basically made a pitch on how we could co-exist," said Gains, describing the inception of the studio. "I saw an opportunity, and having a deep affection for the area since Katrina, I thought there was not only an opportunity, but a chance for doing some good for an area I truly cared about."

Gains first came to work in Louisiana while making 2005's *The Reaping* in Baton Rouge. The timing was not optimal, since while filming the crew was greeted with the devastating effects of Hurricane Katrina. The storm had put making the film into jeopardy, but Gains remembers how locals urged the crew to continue filming.

"The response was not what we expected; everyone wanted us to stay," said Gains. "What Louisiana needed the most at the time was jobs. We had our own internal meetings and felt that if this was going to help the situation, we would stay the course. I just felt connected; the whole thing really did something to me emotionally."

Later on, Gains would remember Louisiana while filming *Green Lantern*. After the initial decision to film in Australia proved untenable, Gains proposed the idea of Louisiana as a destination for the film.

"There were many people who thought I was crazy for doing a film of that size in this market," he said. "It's the kind of movie that you would only do in three or four places in the world, and New Orleans wasn't one of them. I really felt that the success of this production



would have a huge effect on the film industry."

Gains had essentially seen the Louisiana film scene grow around him, but it wasn't until filming *GI Joe: Retaliation* that the opportunity of securing a spacious and reliable facility came into fruition. Gains had previously scouted the Michoud facility while working on *Green Lantern*.

"I explained to the producers that I think New Orleans could work creatively for the movie, but we needed more space," said Gains. "The only way I thought it could work was if we could work out an arrangement with NASA, because I knew at the time that the shuttle program was basically finished."

After months of negotiating the finer details of the arrangement, the deal was struck and Big Easy had a place to call home. The deal resulted in a company that provides high quality production resources, a unique location, and an ethic that genuinely cares about bettering Louisiana through the expansion of the film industry.

The formula has obviously worked, with Big Easy's clientele becoming the envy of production studios around the world. In the few years

of its operations, Big Easy has produced a number of big-budget films, from *Ender's Game* to the upcoming *Jurassic World*.

"We get inquiries almost every week; some are more serious than others," said Gains. "As a supporter of the industry, I want to see as many movies get made here as possible. I think right now we are in a very good place, we have the right amount of work and the right amount of resources." LfV

For more information, visit
www.bigeasystudiosneworleans.com.

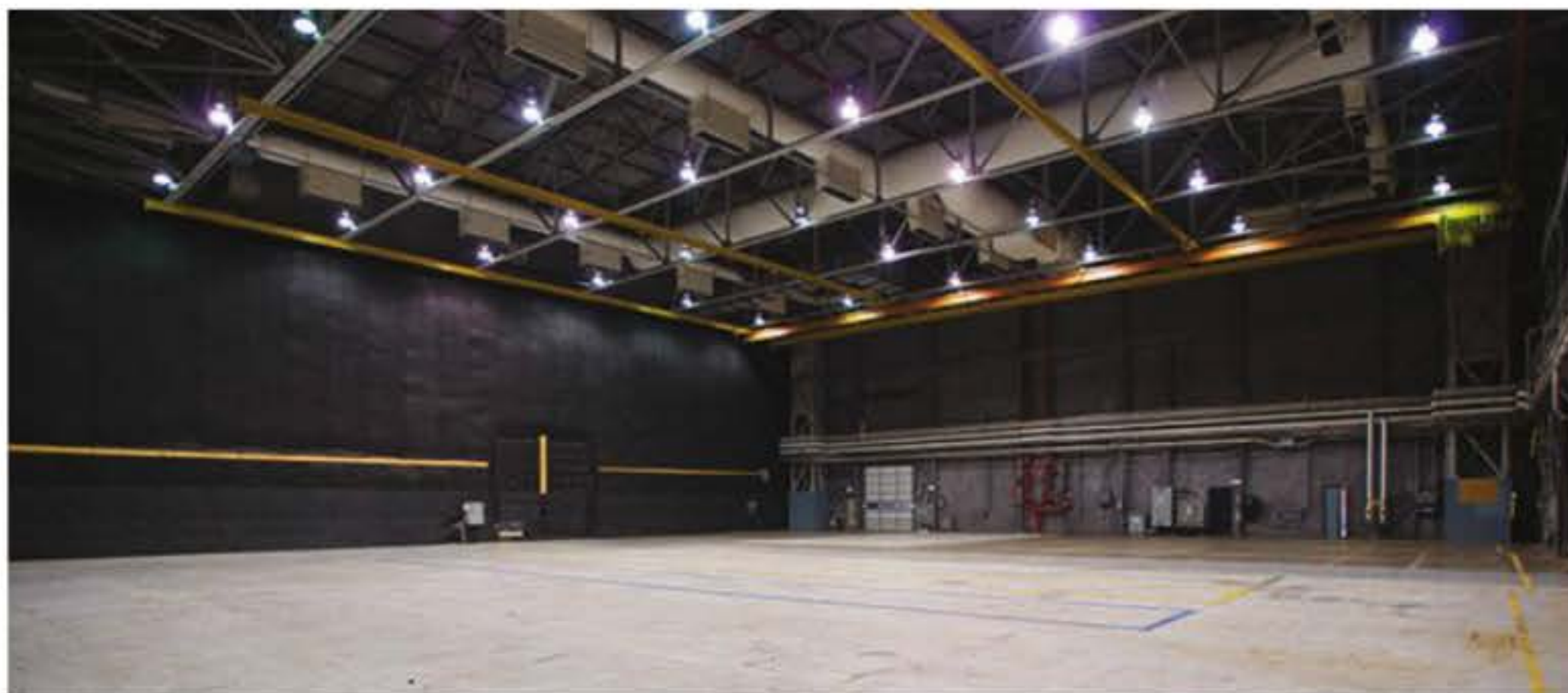

STAGGLE PROFILES

9th Ward Studios
 504-342-4798
www.9thwardstudios.com

**9TH
 WARD
 STUDIOS**

9th Ward Studios, located adjacent to the hip Bywater neighborhood, operates on the site of the "original" sound stage in New Orleans. Formerly Independent Studios, 9th Ward Studios took over the building in 2008 after it suffered major damage from Hurricane Katrina. Since then, the staff has been renovating and improving the studio space, including refacing the standing green screen, installing a new commercial heat and air conditioning unit, and a recent upgrade of the stage lighting. The studio has been a part of such notable films and televi-

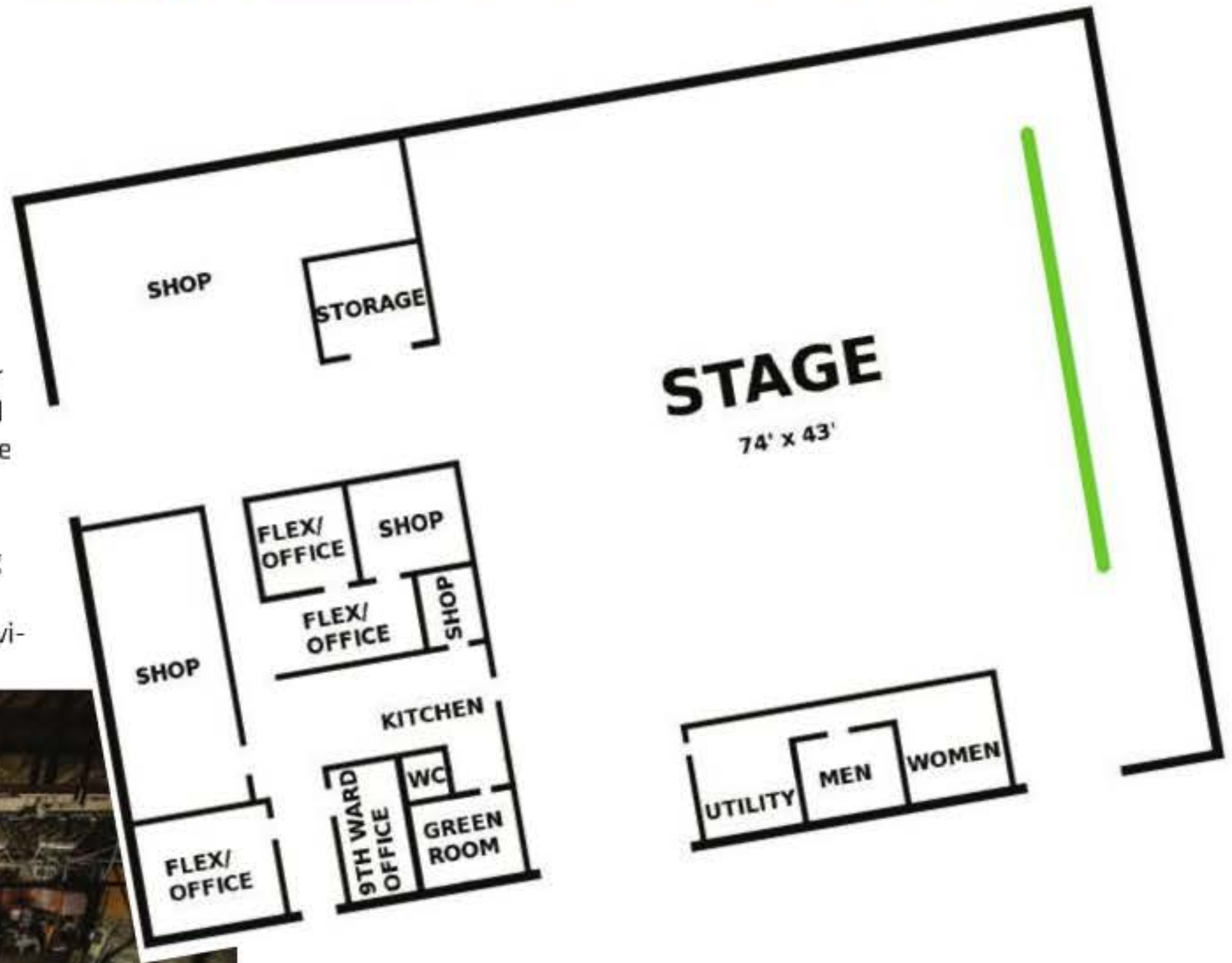

PHOTO BY SCOTT MCKIBBEN

sion shows as *Red*, *Killing Me Softly*, *The Power of Few*, *From the Rough*, *The Lookalike*, *Get Hard*, *Mind Puppet*, and *Queen of Bounce*, as well as numerous commercials and music videos. 9th Ward Studios also remains dedicated to helping independent and student film productions and has provided space for such award winning films and shorts as *Flood Streets*, *Bicycle Season*, *Trust Bob*, *End of the Rainbow*, and the Academy Award nominated *Beasts of the Southern Wild*, which utilized the green screen and studio space while filming their VFX sequences.

Big Easy Studios
 504-254-2070
www.bigeasystudiosnola.com

**BIG
 EASY STUDIOS**

Offering over 250,000 sq. ft., including 8 stages, support space, offices and workshops, Big Easy Studios has everything you need for your next major studio or independent production. Big Easy Studios provides a full range of professional studio

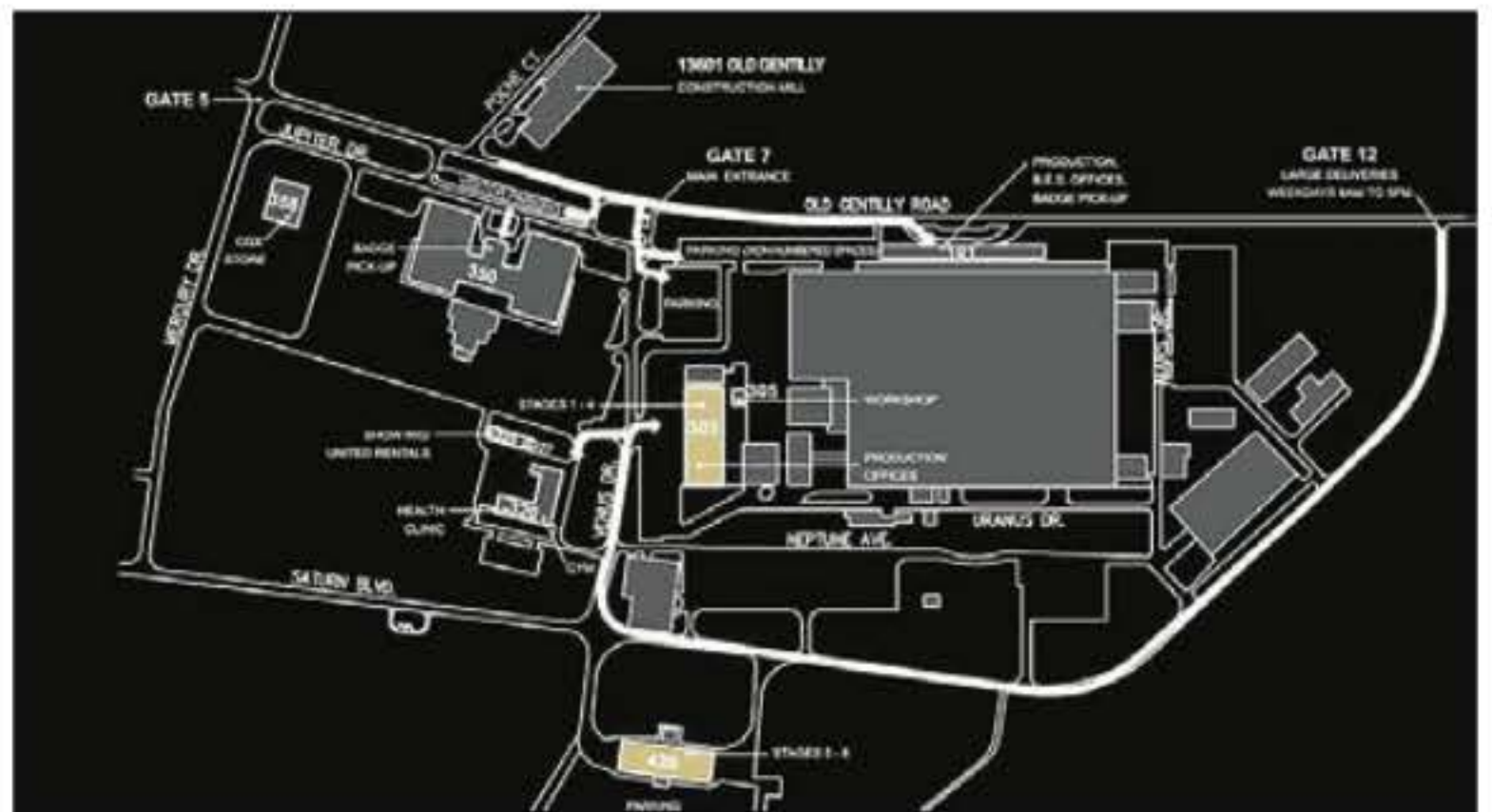

services with complete security, plenty of power and unlimited parking to support your project. Located in New Orleans at the NASA Michoud Assembly Facility, Big Easy Studios has hosted productions such as *GI Joe: Retaliation*, *Ender's Game*, *Dawn of the Planet of the Apes*, *Terminator: Genesis*, *Jurassic World* and *Geostorm*.

BIG EASY STUDIOS

FILM NEW ORLEANS

ALL
YOUR
WORLD
IS
OUR
STAGE

The Hottest Film Destination Now Has a Worthy Studio!



Workshops



Stages

Bring your next production to Big Easy Studios in New Orleans.

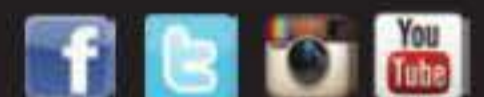

We provide a complete range of Professional Studio Services.
Completely Secure, Plenty of Power, Unlimited Parking

Louisiana has a proven tax incentive, a great crew base with plenty of resources to support your project. The private sector will make you feel welcome and your cast and crew will always have a place to go as this is a city that never sleeps.

OVER 250,000 SQ. FT.

STAGES | SUPPORT SPACE | OFFICES AND WORKSHOPS

Call Us For All Your Production Needs • 504.254.2070 • www.bigeasystudiosnola.com

LOUISIANA STAGES/SOUNDSTAGES

COMPANY CITY, STATE PHONE EMAIL WEBSITE	NUMBER OF STAGES/ SOUNDSTAGES	STAGE DIMENSIONS	DESCRIPTION OF FACILITY	AMENITIES
9th Ward Studios LLC New Orleans, LA 504-342-4798 jasonb@9thwardstudios.com www.9thwardstudios.com	1	74' x 43'	3,200 sq. ft. soundstage facility with a standing 48' long by 15' high pre-lit green screen.	Green room, dressing rooms, 1600 amps of power, 1,000 sq. ft. of office space.
BM&P, LLC New Orleans, LA 504-834-8811 contact@berning.com www.berning.com	1	40' x 30'	Perfect small insert stage for SPFX, green screen, interviews.	5HD Avid suites, complete green room, complete lighting, grip & camera packages. 5-ton grip/lighting truck.
Big Easy Studios New Orleans, LA 504-254-2070 cdantoni@bigeasystudiosnola.com www.bigeasystudiosnola.com	8	Stage 1: 26,285 sq ft, 39' high. Stage 2: 18,154 sq ft, 39' high. Stage 3: 18,154 sq ft, 39' high. Stage 4: 18,154 sq ft, 39' high. Stage 5: 15,471 sq ft, 50' high. Stage 6: 15,471 sq ft, 50' high. Stage 7: 15,390 sq ft, 50' high. Stage 8: 15,390 sq ft, 50' high.	Offering over 250,000 sq. ft. of stages, support space, offices and workshops, Big Easy Studios has everything you need for your next major studio or independent production.	Big Easy Studios provides a full range of professional studio services with complete security, plenty of power and unlimited parking to support your project.
Celtic Studios Baton Rouge, LA 225-330-6000 info@celticmediacentre.com www.celticmediacentre.com	7	Stages 1 & 2 located in the O'Connor building at 1,100 sq. ft. and 6,500 sq ft. Stages 4, 5, 6, 7 and 8 located inside the main lot ranging from 22,270 sq. ft. to 30,800 sq. ft. 3 acres of back-lot space.	With nearly 150,000 square feet of design-built stage space and 90,000 square feet of gated office space, the Celtic Media Centre has the size and services to meet the demands of most any production.	Our 30-acre facility offers 7 stages, office space, production support services, post services, rentals and vendors including the country's largest studio based grip & lighting supplier, MBS Equipment Co.
CRM Studios Louisiana Shreveport, LA 318-629-8620 greglawrence@crmstudios.tv www.crmstudios.tv	1	32' x 29' with 12' ceiling height to the lighting grid.	Sound proof, 32' x 29' sound stage with green screen.	Pre-lit green infinity wall 32' x 24', Protocols audio, Wisper Booth, ADR, Motion Capture. Cameras, floor lights, crew, DP, gaffer/grip also available.
Digital FX, Inc. Baton Rouge, LA 225-763-6010 info@digitalfx.tv www.digitalfx.tv	1	75' x 50' x 28' ceiling height w/ 90' hard cyc. Sound isolated and full light grid. State of the art, brand new, and full of creature comforts, our studio can accommodate any number of film and video shoots, still photography sessions and dedicated visual effects shots.	Largest visual effects studio in Gulf Coast. Emmy Award winning team, with best facility in region.	Editorial suites, VFX suites, amazing studio, make-up suites, green room, gym, kitchen.
Indie Stages Baton Rouge, LA 225-308-5963 info@indiestages.com www.indiestages.com	1	6,000 square feet	Conveniently located off of Interstate I-110 in Baton Rouge, Indie Stages offers move in ready, turnkey film and television production space.	The campus includes up to 15,000 square feet of production office space, up to 11,000 square feet mill and storage space, and over 300 parking spaces. Furniture, phone and internet service is installed and operating.
Launch Media/Creative Bloc Baton Rouge, LA 225-612-2112 eric@launchmedia.tv www.launchmedia.tv	1	Size: 2200 sq. ft. - 17' ceiling height - 63ft. x 35ft. 10' x 10' loading door. Amperage 400 (2 x 200 amp panels). 2 x 15 ton HVAC units. Pre-lit 40' fabric, lighting grid.	Easy access; near I-110 & BR Airport. Located in Downtown Baton Rouge.	Green room, makeup/changing area, kitchenette, outdoor/green space, temp production offices, voice over booth & control room, fiber Internet access.
Millennium Studios Shreveport, LA 318-841-3599 info@millenniumstudios.net www.millenniumstudios.net	2	Stage 1 is 15,000 sf and Stage 2 is 10,000 sf.	N/A	We have offices, wardrobe work room, construction mill, trailers, walkies, and much more.